

1 DUMPSTER ENCLOSURE PLAN

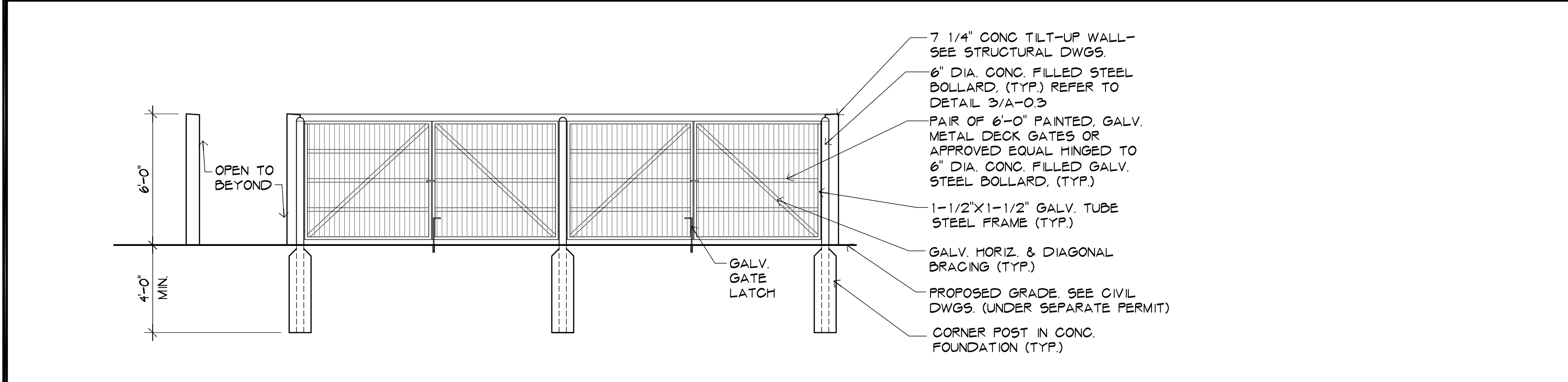

2 DUMPSTER ENCLOSURE ELEVATION

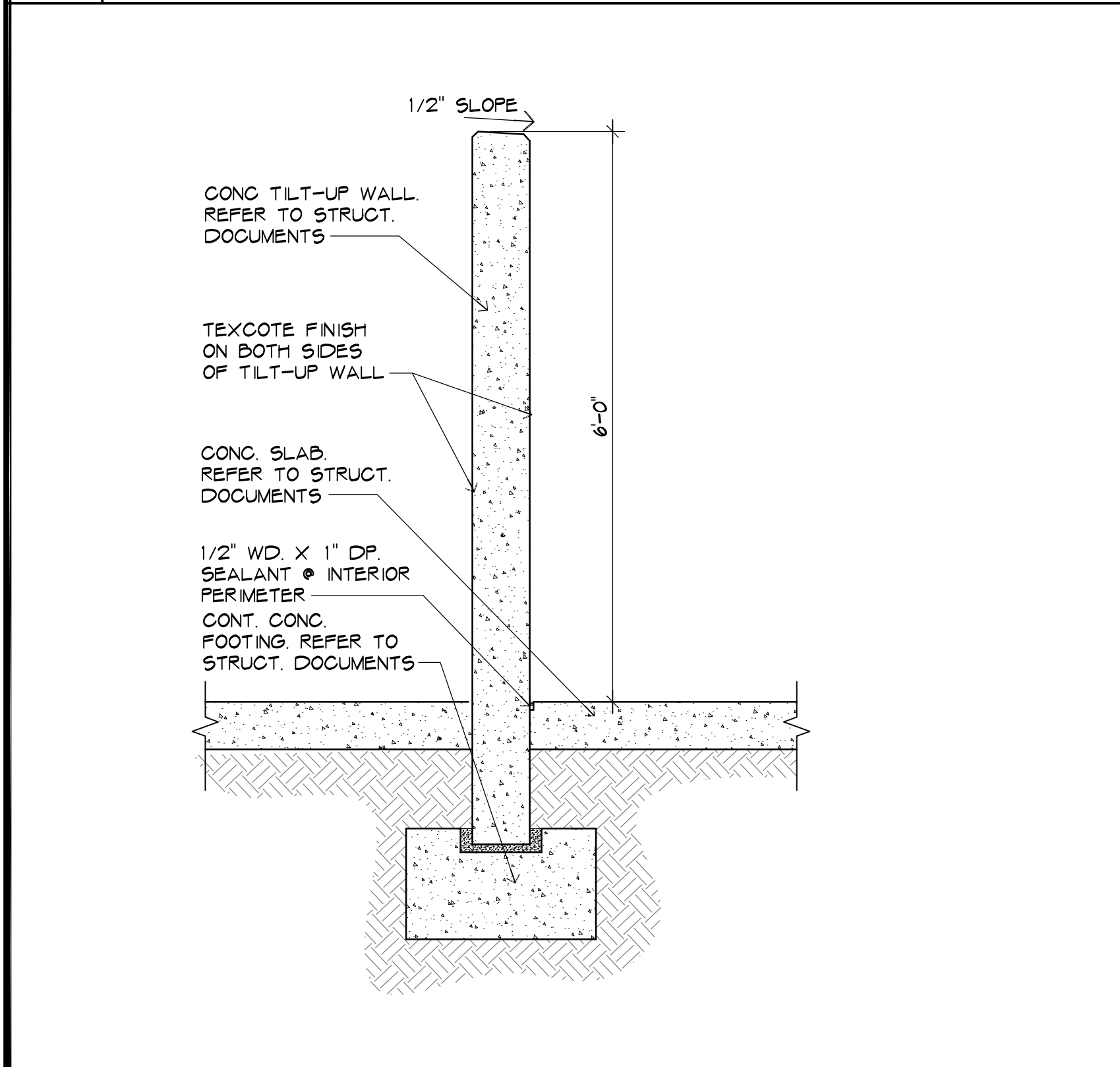

3 DUMPSTER WALL DETAIL

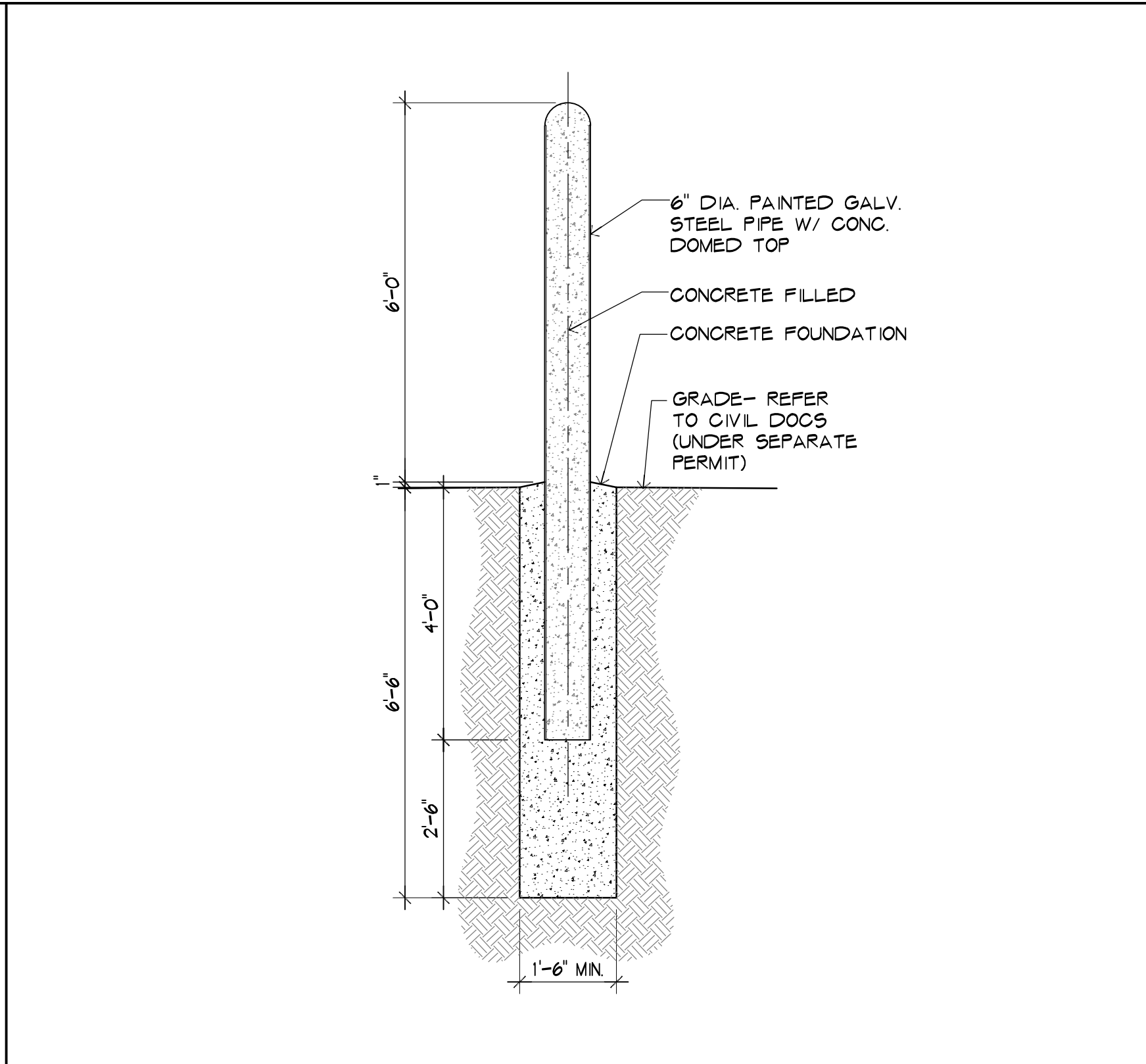

4 BOLLARD DETAIL

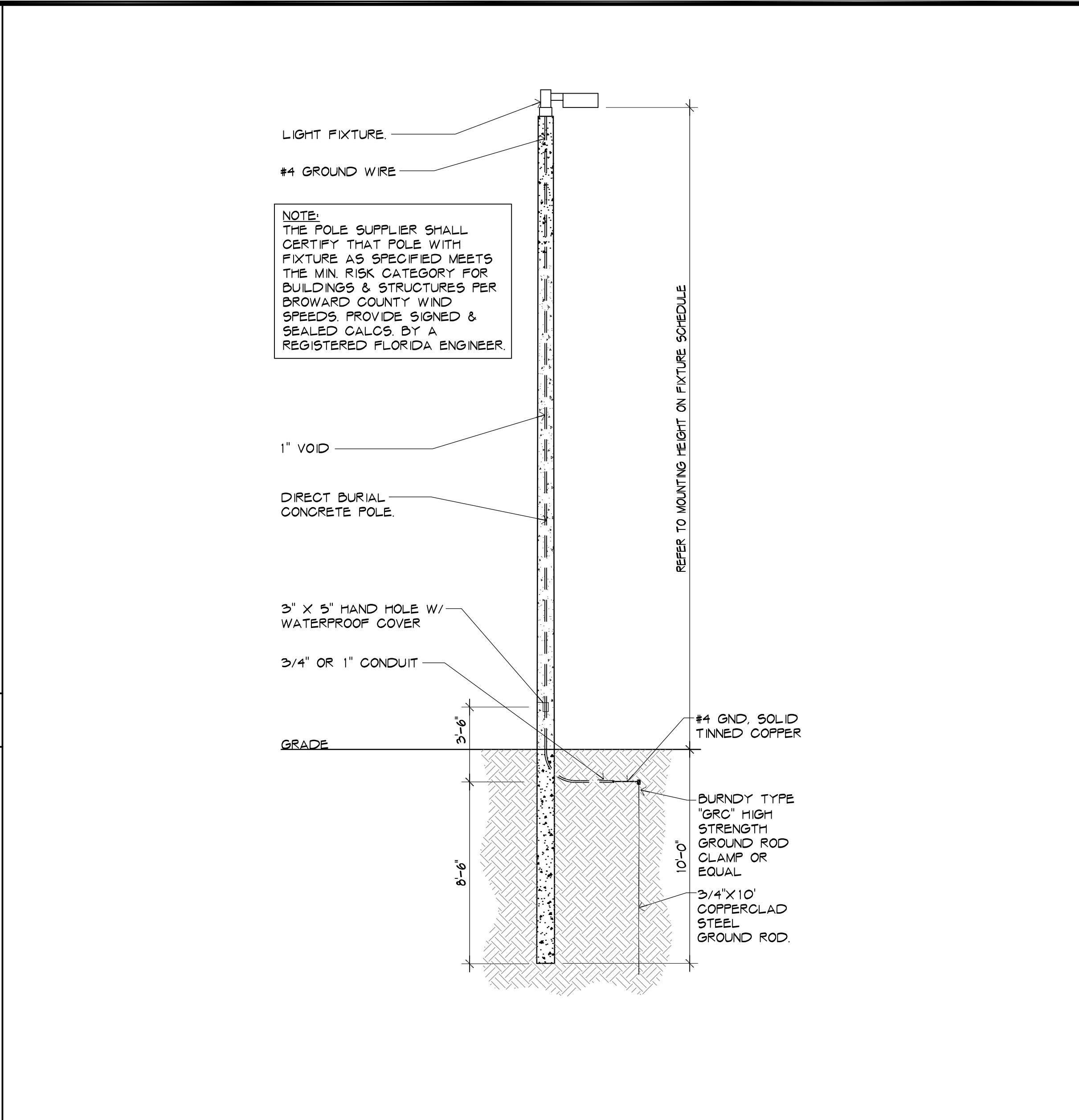

5 LIGHT POLE DETAIL

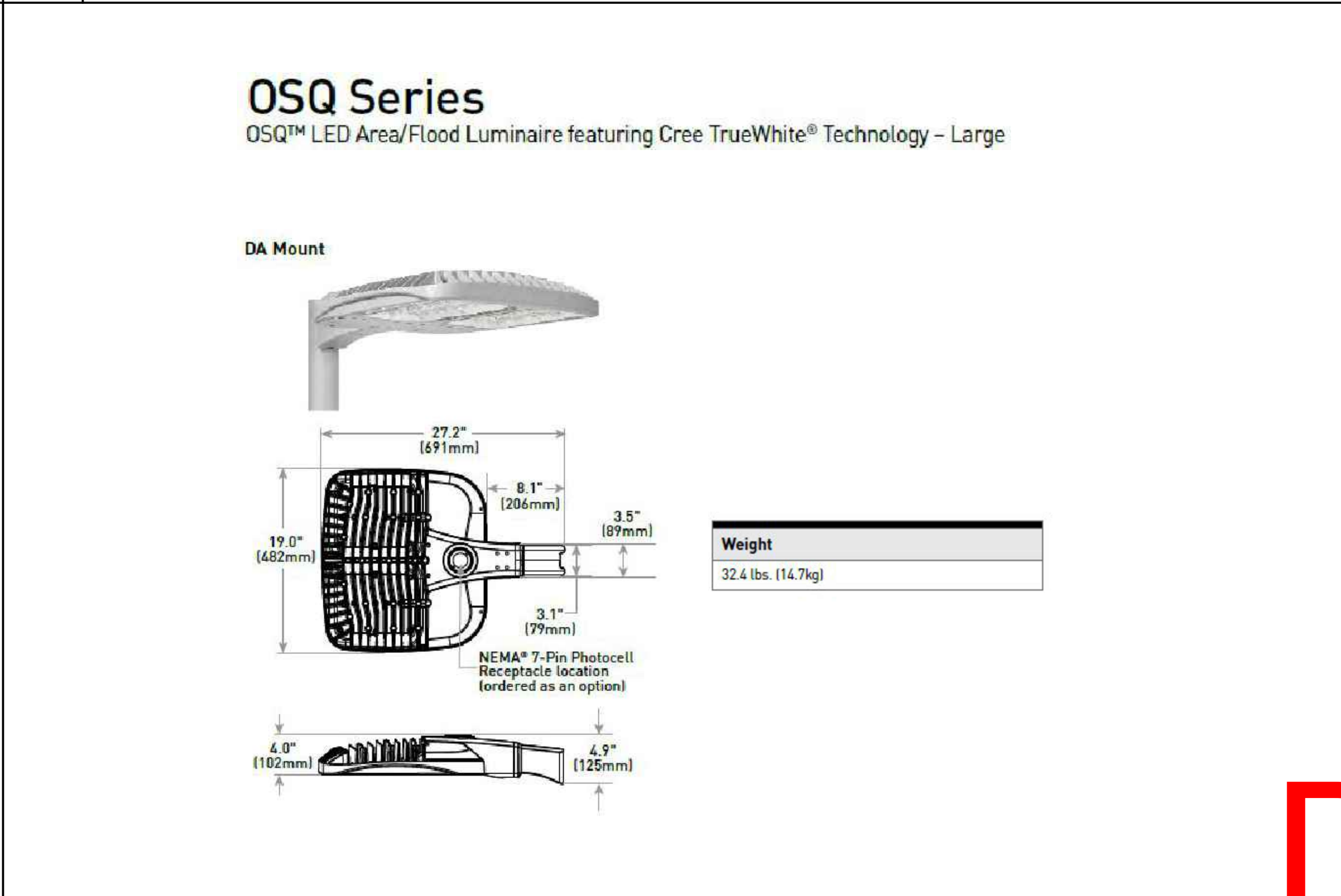

6 LIGHT POLE AND WALL MOUNTED FIXT.

FIRST ANDREWS
LOGISTICS CENTER
1801 N Andrews Avenue
Pompano Beach, FL 33069

NO. DATE REVISION

ALL DRAWINGS, SPECIFICATIONS AND RELATED DOCUMENTS ARE THE COPYRIGHT PROPERTY OF THE ARCHITECT AND MUST BE RETURNED UPON REQUEST. REPRODUCTION OF DRAWINGS, SPECIFICATIONS AND RELATED DOCUMENTS IN PART OR WHOLE IS FORBIDDEN WITHOUT THE ARCHITECT'S WRITTEN PERMISSION.

CONTRACTOR MUST CHECK AND VERIFY ALL DIMENSIONS AND FIELD CONDITIONS AND NOTIFY ARCHITECT/ENGINEER IMMEDIATELY OF ANY DISCREPANCIES.

HNM
HNM ARCHITECTURE

3705 North Federal Highway • Delray Beach, Florida 33483 • T. 561.733.2225
info@hnm-architecture.com • A20000729 • www.hnm-architecture.com

Digitally signed by Michael Hanlon
Date: 2023.01.25 10:40:59-05'00'

MICHAEL W. HANLON
FLORIDA REGISTERED ARCHITECT - REG. NUMBER: AR0017270
ELECTRONIC SIGNATURE SERIAL NUMBER:

HNM PROJECT NUMBER
22-013

ISSUED DATE
2023-01-25

SCALE
AS NOTED

TITLE
SITE PLAN DETAILS

DRAWING NUMBER
A-0-3

DRC

P222-12000052
03/01/2023